

Diğer Ürünler
Other Products

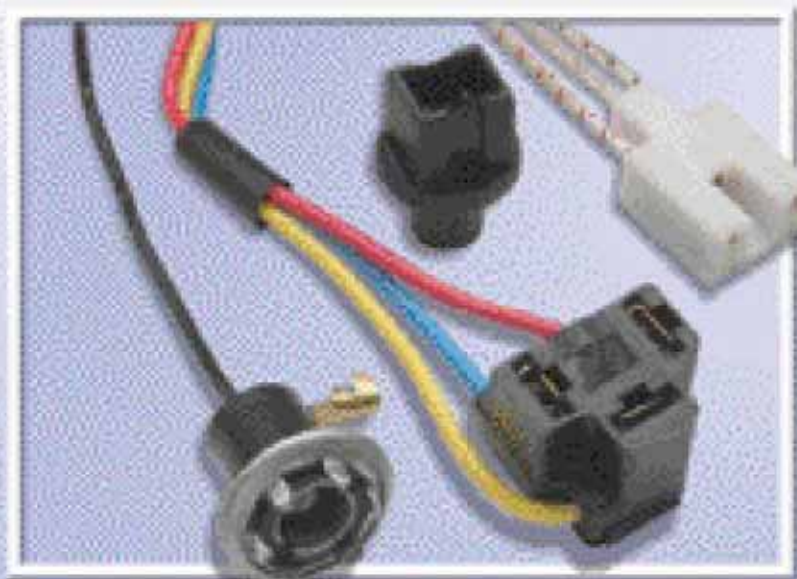

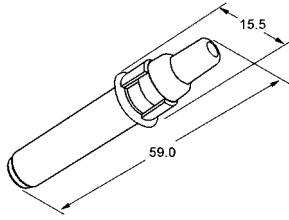

| Ürün Tanımı | Ürün Kodu | Malzeme | Yanmazlık Derecesi | | Renk | Paketleme Miktarı (Adet) |
|--------------------------|--------------|----------|--------------------|----|-------------------|--------------------------|
| | | | V0 | V2 | | |
| Description | Product Code | Material | Flammability Class | | Color | Packing Unit (Pieces) |
| | | | V0 | V2 | | |
| ARA SİGORTA Fuse case | 0700280003-0 | PA 66 | ○ | ● | Şeffaf Natural | 100 |
| ARA SİGORTA Fuse case | 0740280003-0 | PA 66 | ● | ○ | Şeffaf Natural | 100 |

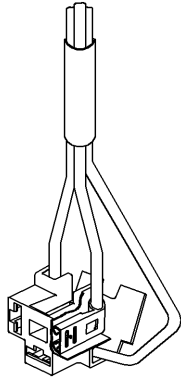

| | | | | | | |
|---|--------------|-------|---|---|-------------------|----|
| ATOM FAR FIŞİ - MON. 1.5 - 2.5 Headlamp insulation housing assambled 1.5 - 2.5 | 9700380007-0 | PA 66 | ○ | ● | Şeffaf Natural | 20 |
| ATOM FAR FIŞİ - MON. 1.5 - 2.5 Headlamp insulation housing assambled 1.5 - 2.5 | 9710380007-0 | PA 66 | ● | ○ | Şeffaf Natural | 20 |
| ATOM FAR FIŞİ - MON. 0.75 - 1.5 Headlamp insulation housing assambled 0.75 - 1.5 | 9700380005-0 | PA 66 | ○ | ● | Şeffaf Natural | 25 |
| ATOM FAR FIŞİ - MON. 0.75 - 1.5 Headlamp insulation housing assambled 0.75 - 1.5 | 9710380005-0 | PA 66 | ● | ○ | Şeffaf Natural | 25 |

6.3mm

| Ürün Tanımı | Ürün Kodu | Malzeme | K a p l a m a | | | Malzeme Kalınlığı (mm) | Ağız Genişliği (mm) | Ambalaj Miktarı (Adet) |
|-------------|--------------|----------|---------------|----|----|-------------------------|---------------------|---------------------------|
| | | | Kaplamasız | Sn | Ni | | | |
| Description | Product Code | Material | P l a t i n g | | | Material Thickness (mm) | Tab Width (mm) | Standard Packing (Pieces) |
| | | | Unplated | Sn | Ni | Ag | | |

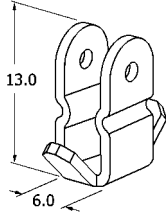

| | | | | | | | | | |
|----------------------------|------------|-----|---|---|---|---|-----|---|-----|
| SUBAP ŞAPKASI Valve cap | 0400280002 | DKP | ● | ○ | ○ | ○ | 1.0 | - | 500 |
|----------------------------|------------|-----|---|---|---|---|-----|---|-----|

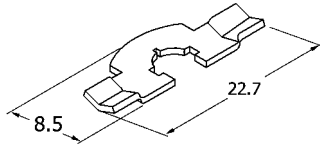

| | | | | | | | | | |
|---|------------|------|---|---|---|---|-----|---|------|
| ŞALTER KÖPRÜSÜ Switch bridge contact | 0100280001 | CuZn | ● | ○ | ○ | ○ | 0.8 | - | 1000 |
| ŞALTER KÖPRÜSÜ Switch bridge contact | 0101280001 | CuZn | ○ | ● | ○ | ○ | 0.8 | - | 1000 |
| ŞALTER KÖPRÜSÜ Switch bridge contact | 0103280001 | CuZn | ○ | ○ | ○ | ● | 0.8 | - | 1000 |
| ŞALTER KÖPRÜSÜ Switch bridge contact | 0400280002 | DKP | ● | ○ | ○ | ○ | 0.8 | - | 1000 |